

# Installation Guide

## for Replacement Screen Housing for Andersen® LuminAire® Sliding Patio Retractable Insect Screen Door

For installation help please visit [www.AndersenLuminAire.com/install](http://www.AndersenLuminAire.com/install)

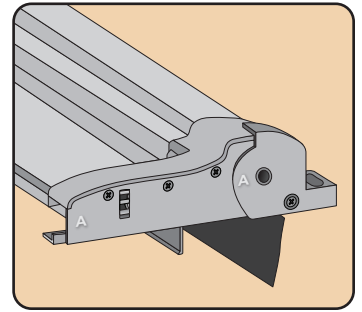

**Please Do Not Return Product to Store!**

**PLEASE** call the Storm Door Solution Center at 844-813-6664, with any questions regarding installation, lost part replacement, or anything else related to your retractable insect screen purchase. Replacement parts can also be found at: [parts.andersenstormdoors.com](http://parts.andersenstormdoors.com)

**Read this entire guide before you begin your installation. If your abilities do not match the requirements of this installation, contact an experienced contractor.**

### SCREEN HOUSING REPLACEMENT PART OVERVIEW

Your installation kit should contain the following parts.

- 1** Screen Housing
- 2** End Caps (attached to ends of housings)
- 3** Orange Installation Clips
- 4** Shipping Plastic Wrap
- 5** **Not Shown:** Green Parts Bag containing:
  - Mounting Bracket Shim (qty 1)
  - Mounting Bracket Slot Cover (qty 2)
  - Shim Tape - two sided (qty 6)
  - Installation Tape (qty 1)
  - Track Filler Foam (qty 1)
  - 1/4", 3/8" and 1/2" Spacers (qty 2 each)
- 6** **Not Shown:** Red Screw Pack containing:
  - 1 inch #8 screws (qty 3)
  - 3/4 inch #6 screws (qty 4)
  - 3 inch #8 screws (qty 2)
  - #2 Phillips Bit
  - 1/8 inch and 3/32 inch Drill Bit

#### NOTICE

- To avoid product damage, the orange installation clips attached to the Screen Housing provide product protection. DO NOT extend the screen from the housing or remove installation clip until instructed to do so.
- To avoid product damage, be sure to place all parts of your retractable insect screen on a soft non-abrasive surface such as carpet, drop cloth placed on your lawn or cardboard.

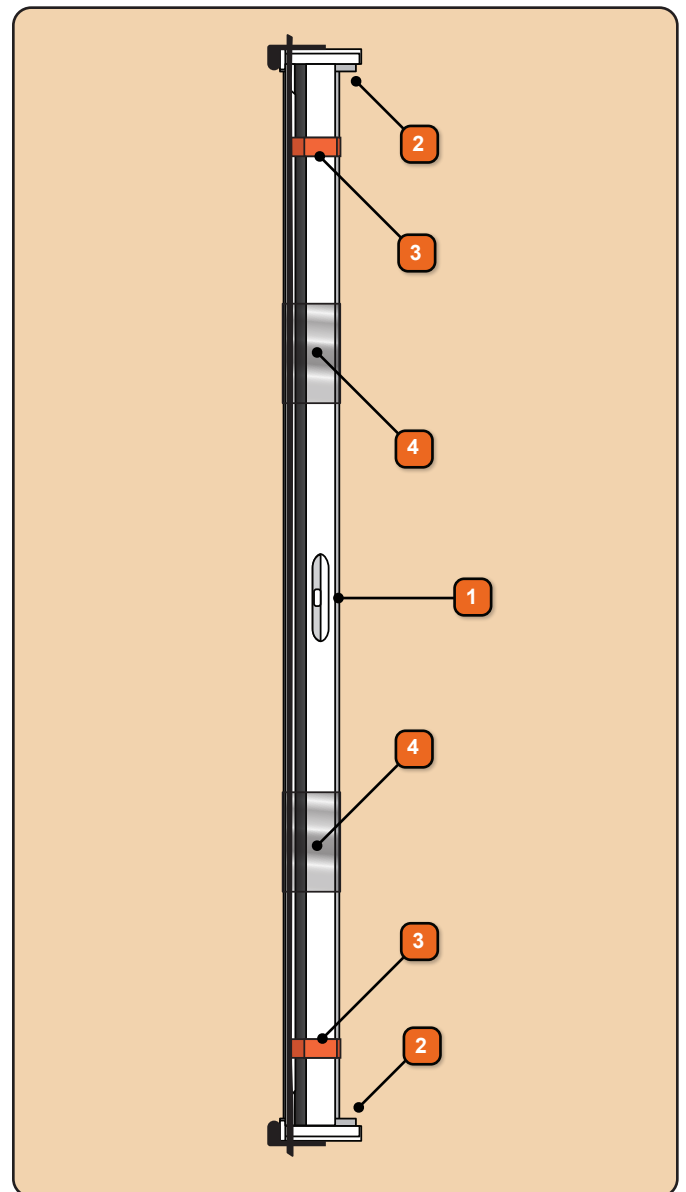

Emco Enterprises, Inc., is a wholly owned subsidiary of Andersen Corporation. Emco Enterprises, Inc. manufactures and supports the limited warranties for Andersen® and EMCO® doors. "Andersen", "EMCO" and all other marks where denoted are trademarks of Andersen Corporation. ©2025 Andersen Corporation. All rights reserved.

Andersen SDD, PO Box 853  
Des Moines, IA 50306-0853  
Rev 4-2025 r1 Print in Color

**p/n 905998**

## SAFETY FIRST: Please read and follow all Cautions and Warnings in this guide.



### Signal Word and Consequence

This is the Safety Alert Symbol used to alert you to potential injury hazards. Obey all safety messages that follow this symbol to avoid possible injury or death.

**COULD** Result in:



**WARNING**

Major Injury or Death

**COULD** Result in:



**CAUTION**

Minor Injury

**COULD** Result in:

**NOTICE**

Product or Property Damage

**IMPORTANT**

Procedure and Product Information

### **WARNING**

Follow manufacturers' instructions for hand and power tools. Always wear safety glasses. Failure to do so could result in injury, product or property damage.

### **WARNING**

Windows and doors can be heavy. Use safe lifting techniques and a reasonable number of people with enough strength to lift, carry, and install window and door products. Heavier windows and doors will require mechanical assistance. Failure to do so could result in injury, product or property damage.

### **CAUTION**

Metal components of the retractable insect screen may become hot when exposed to sunlight.

### **WARNING**

Windows and doors have small parts (e.g. hole plugs, slot covers, spacers, fasteners, etc.). Small parts if swallowed could pose a choking hazard to young children. Dispose of unused, loose, or easily removed small parts. Failure to do so could result in injury.

### **CAUTION**

Retractable screen and installation components can have sharp edges. Wear protective equipment when handling. Failure to do so could result in injury.

### **WARNING**

- Metal fasteners and components could corrode when exposed to preservative-treated or fire-retardant treated lumber. Use approved fasteners and components to fasten window or door. Failure to do so could cause a failure resulting in injury, product or property damage.
- Fastener must attach to a structural framing member with a 1" minimum fastener embedment. Failure to do so could result in injury, product or property damage.
- **DO NOT** remove screws that attached installation clips or gusset plates to window or door frames. Doing so could result in injury, product or property damage.

### **CAUTION**

Follow instructions of foam, sealant, and flashing manufacturers regarding safety, material application, compatibility, and periodic maintenance for continued weather resistance of their products. Failure to do so could result in injury, product or property damage.

### **NOTICE**

Do not install retractable screen on your gliding patio door if temperature is below 40°F (4.44°C)

### **NOTICE**

- Clean and prepare surfaces receiving sealant following sealant manufacturer's instructions. Failure to do so could result in water infiltration causing product or property damage.
- **DO NOT** use abrasive cleaners or solvents when cleaning Fibrex® material. Doing so could result in product damage. Go to andersenwindows.com for a list of recommended cleaners.

### **IMPORTANT**

The retractable insect screen is intended for reasonable insect control and not the retention of objects, persons, or pets within the interior. The retractable insect screen will not stop a person from falling through the door.

### **NOTICE**

If the patio door or the trim materials installed around it are brittle, rotten, unstable, or do not have adequate attachment area so that the LuminAire® retractable screen cannot be installed correctly, the sliding insect screen door's performance may be impacted over time. Product or property damage could occur.

## RECOMMENDED TOOLS



Safety Glasses

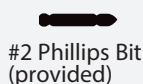

#2 Phillips Bit (provided)



Soft Cloth



Sealant (not provided)



Drill/Driver



Screwdrivers



Scissors



Masking Tape

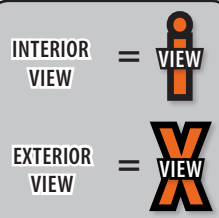

Interior view and exterior view icons are displayed on each illustration to indicate if you're viewing the step from the interior of the opening or the exterior of the opening. They are displayed in each step to help with the orientation of the view being shown.

1

## PREPARE THE RETRACTABLE SCREEN DOOR

### Tools Recommended:

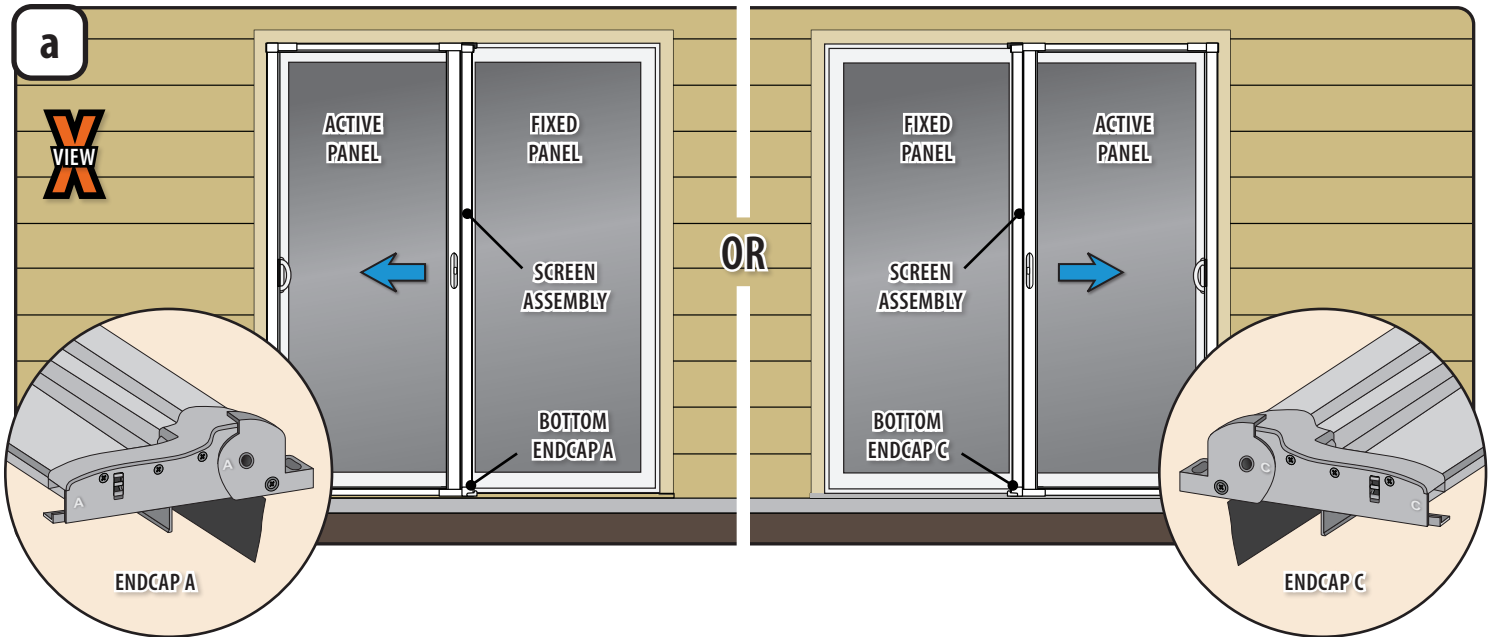

- a1** LuminAire Retractable Screen Doors come with universal handing, so take note of the **Screen Assembly's** orientation. This will be the orientation the **Screen Assembly** should be reinstalled in. Left Side Active Panel **Endcap A** will be at the Bottom or for Right Side Active Panel **Endcap C** will be at the Bottom, a photo can help as reference.

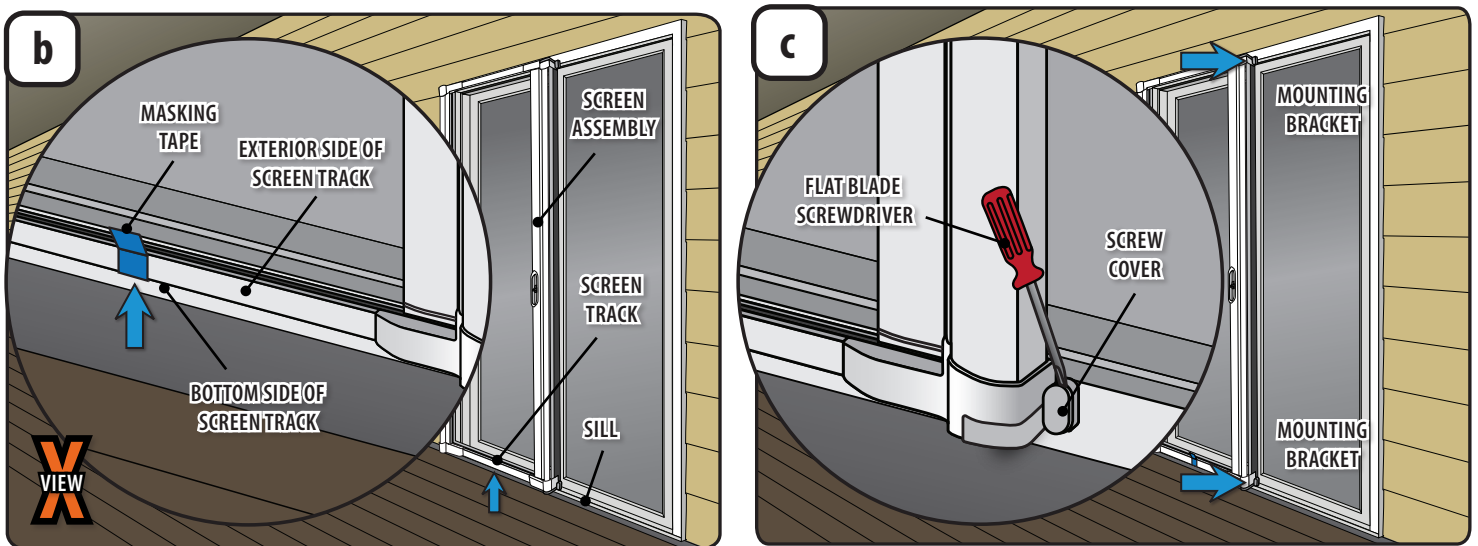

- b1** At the bottom of the **Screen Assembly** in the center of the **Screen Track**, apply **Masking Tape** starting at the **Bottom Side** of the **Screen Track**, wrapping it around to the **Exterior Side** of the **Screen Track**. Leaving a tag end loose for removal in a later step.

- c1** With a **Flat Blade Screwdriver**, remove the **Screw Covers** from the upper and lower **Mounting Brackets**. Dispose of the **Screw Covers** properly.

# 2

## SCREEN ASSEMBLY REMOVAL AND DISASSEMBLY

### Tools Recommended:

#2 Phillips Bit  
(provided)

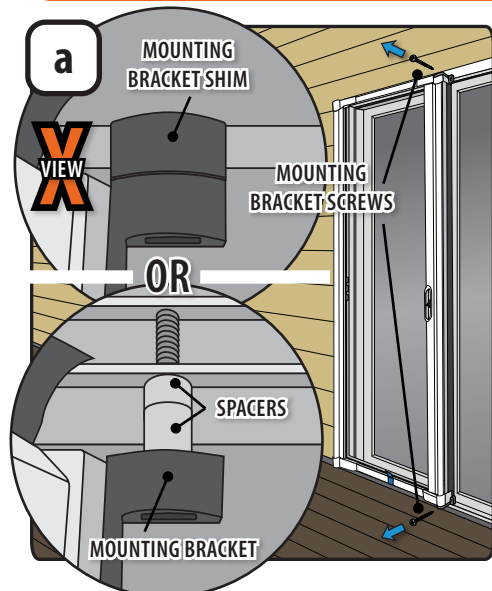

- a1** Inspect behind both **Mounting Brackets**. Make a note of what **Shim** or **Spacers** are used. The same combination must be used for reinstallation. A photo can help as reference.
- a2** From the exterior of the screen housing, remove the top and bottom **Mounting Bracket Screws**. Dispose of properly.

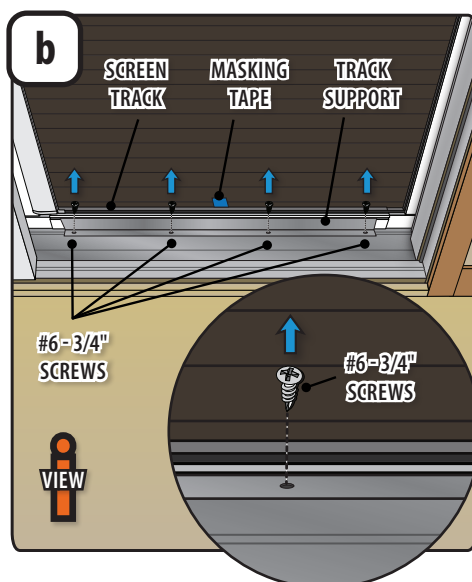

- b1** From inside the screen housing, remove the four(4) #6-3/4" Screws from the **Track Support**. Dispose of properly.

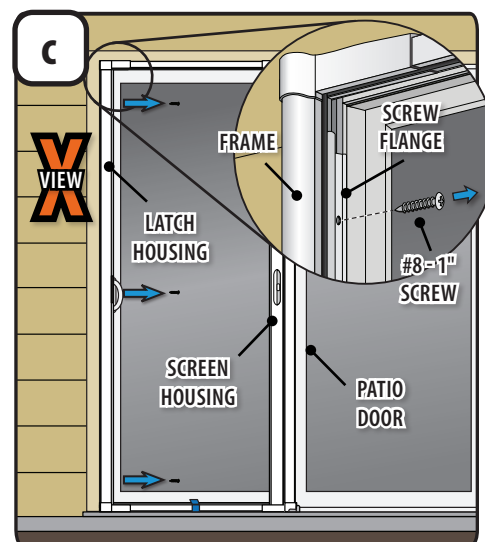

- c1** Firmly hold the **Screen Housing** against the **Patio Door** and remove the three (3) #8-1" Screws from the **Screw Flange** on the **Latch Housing**. Dispose of properly.

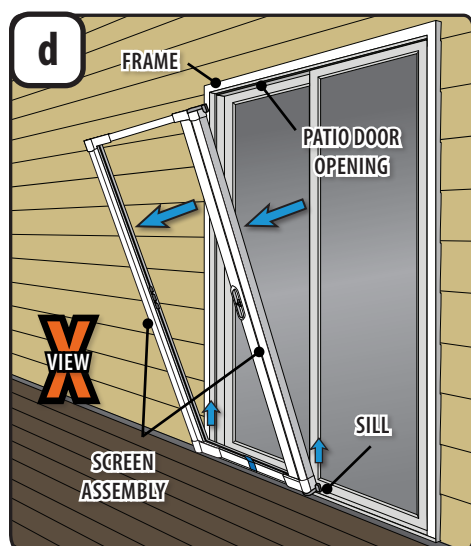

- d1** Tip and lift **Screen Assembly** out of **Patio Door Opening** and place it flat on a non-abrasive surface with interior side facing up.

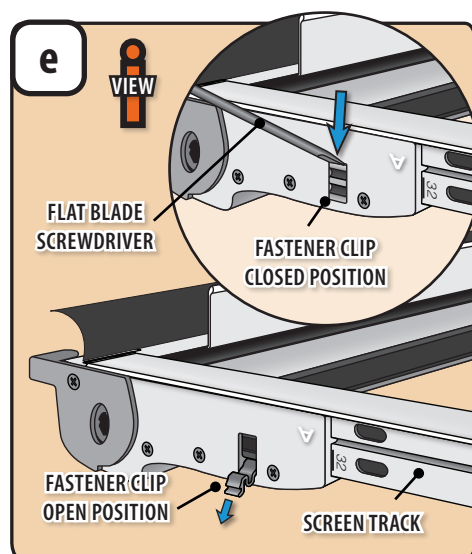

- e1** On the **Screen Track**, make a note of which line the installation uses (32 shown). This is the same line that should be used for reassembly. A photo can help as reference.
- e2** On endcap A, with a **Flat Blade Screwdriver**, apply downward pressure on the **Fastener Clip** and rotate into the open position.
- e3** Repeat this step for endcap C.

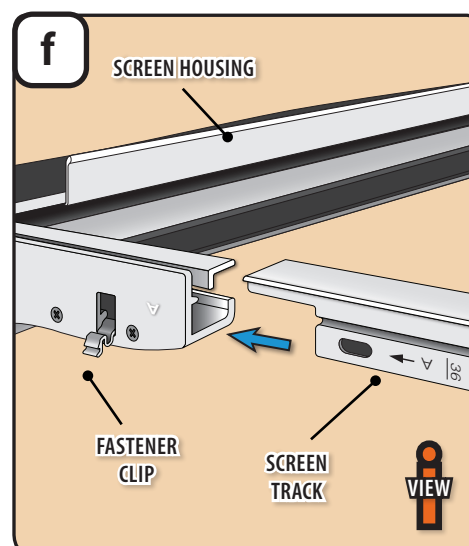

- f1** With both **Fastener Clips** in the open position, slide the **Screen Housing** off of both **Screen Tracks** (sides A and C). Dispose of the **Screen Housing** properly.

# 3

## REASSEMBLE SCREEN TRACKS & HOUSINGS

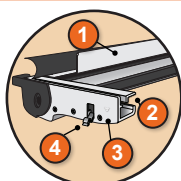

Screen Housing

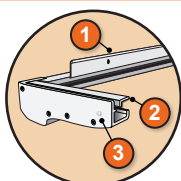

Latch Housing

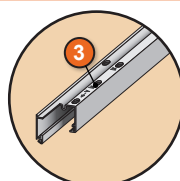

Screen Track (A/B)

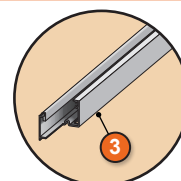

Screen Track (C/D)

### KEY REFERENCES

- 1 Flange
- 2 Receiving Tabs
- 3 Letter Labels
- 4 Fastener Clips

**a** ALL ITEMS DURING THE ASSEMBLY STEPS SHOULD BE LAYING FLAT ON THE GROUND

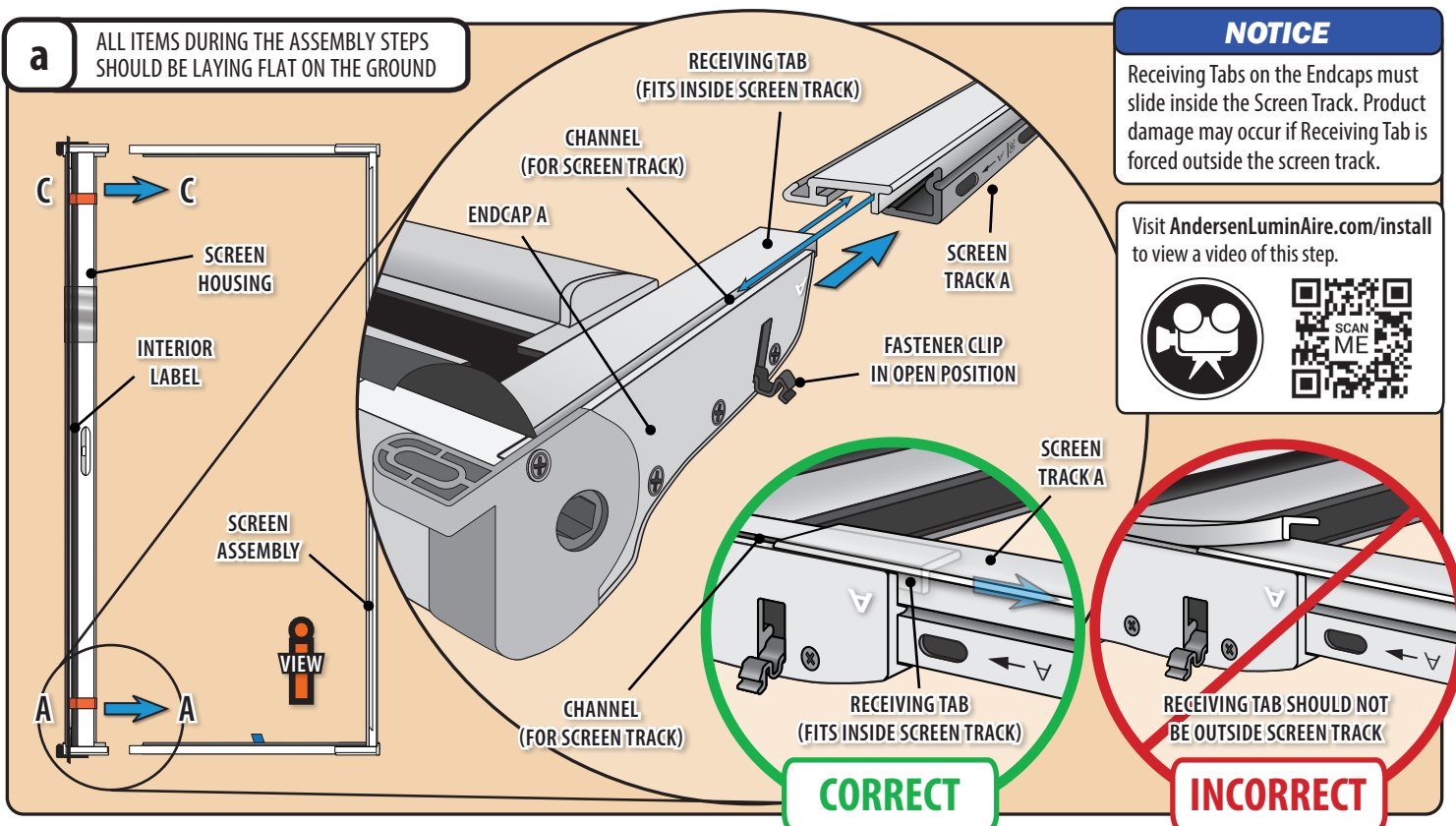

- a1** With the replacement **Screen Housing** and existing **Screen Assembly** on a non-abrasive surface, make sure the side labeled **Interior** is facing up. Leaving the screen in the retracted position, arrange the components so the letters marked on the **Screen Tracks** and on the **Endcaps** align (A to A, and C to C).
- a2** Confirm the **Fastener Clips** on endcaps A and C are in the open position. Starting at corner A, slide the **Receiving Tab** on **Endcap A** inside the **Screen Track**. Ensure the **Receiving Tab** fits inside the **Screen Track**, and the **Screen Track** slides into the **Channel**. (see "correct" above). Repeat for corner C.
- a3** Use the same configuration in Step b as was noted from step e, section 2 while disassembling the **Screen Housing** from the assembly.

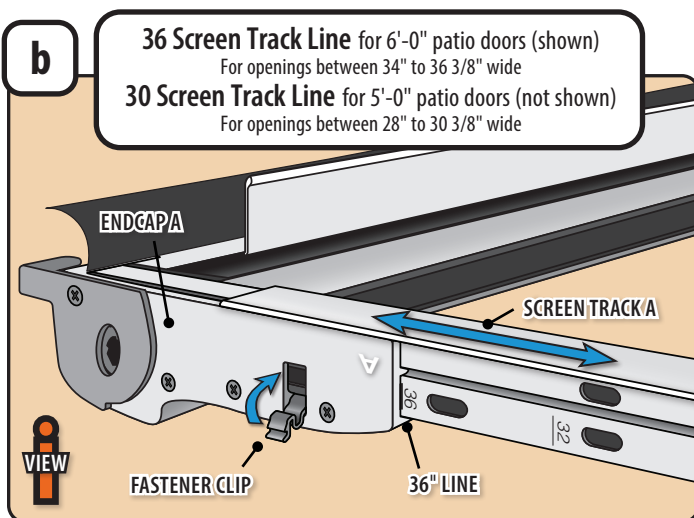

- b1** Using the line noted in step e, section 2, align it with the edge of **Endcap A**.
- b2** Rotate the **Fastener Clip** up until it snaps into the closed position.
- b3** Repeat steps for side C.

OR

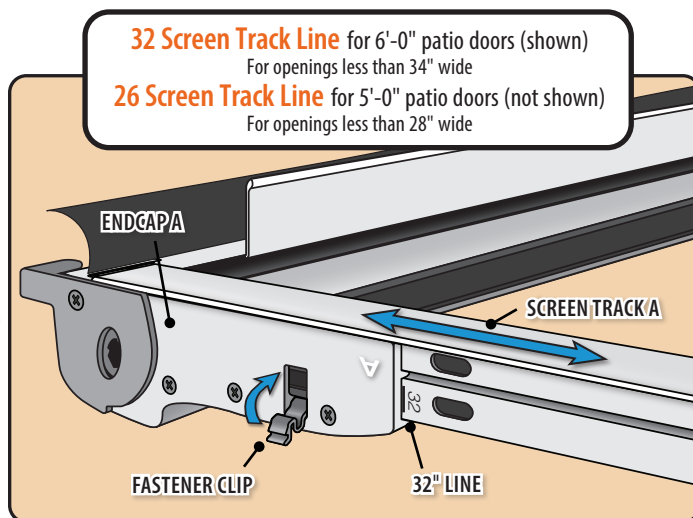

- b1** Using the line noted in step e, section 2, align it with the edge of **Endcap A**.
- b2** Rotate the **Fastener Clip** up until it snaps into the closed position.
- b3** Repeat steps for side C.



4

## PLACE AND INSTALL SCREEN ASSEMBLY INTO OPENING

### Tools Recommended:



Drill/Driver



Scissors

Phillips  
Screwdriver#2 Phillips Bit  
(provided)

### SCREW/PACK

#8-1"  
(Qty 3)

### PARTS/BAG

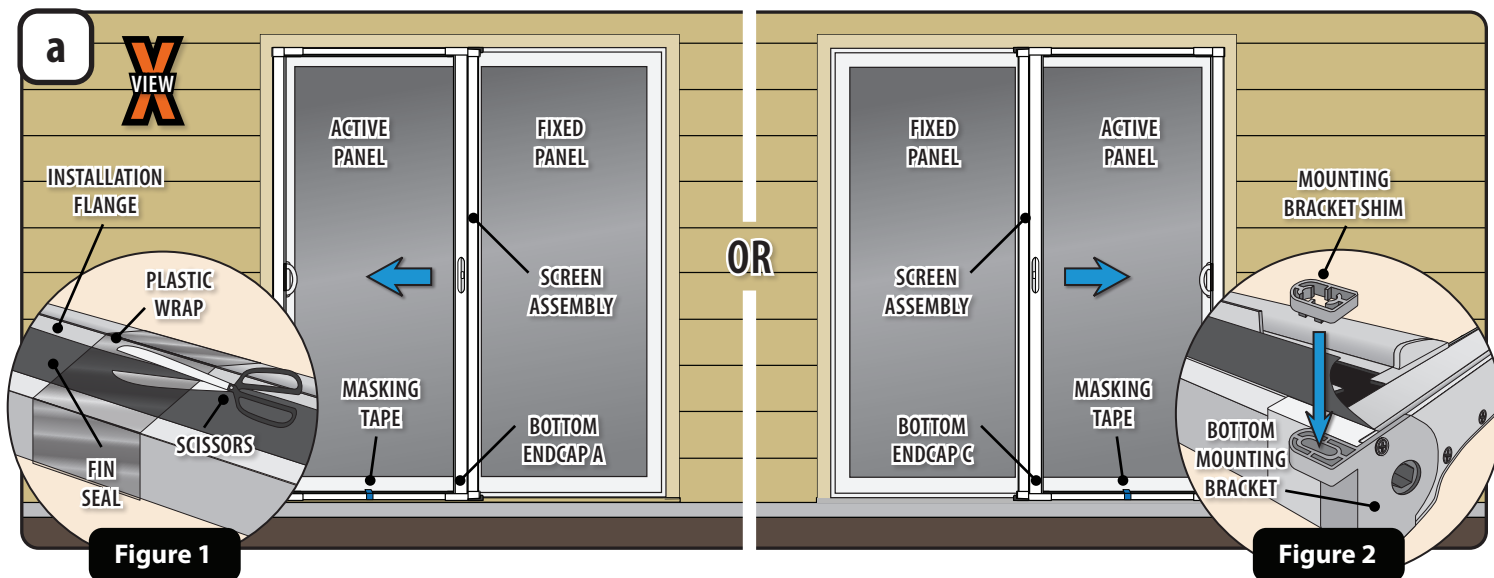
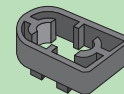
Mounting  
Bracket Shim

**a1** With a scissors, cut **Plastic Wrap** along inside edge of **Installation Flange** avoiding the black rubber **Fin Seal**, see Figure 1.

**a2** Determine the proper orientation of the retractable insect **Screen Assembly** based on the noted orientation from Step a, section 1.

**a3** If in Step a, section 2 you noted your installation had a **Mounting Bracket Shim**, install it onto the **Bottom Mounting Bracket**, see Figure 2.

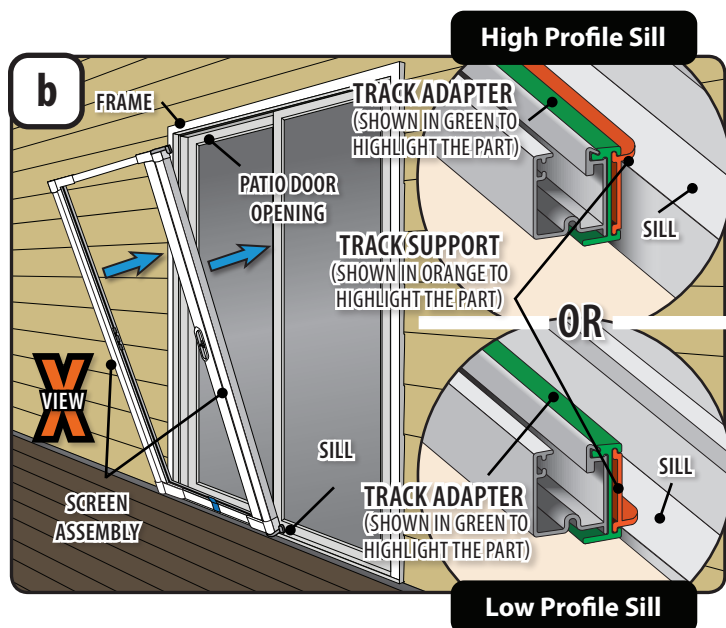

**b1** The **Screen Assembly** will be narrower than your opening until fully expanded in the following steps.

**b2** Start by placing the **Screen Assembly** onto the exterior **Sill**, with the screw flanges extending into the **Patio Door Opening**. With the flange of the **Track Support** resting on top of the **Sill**, tip the assembly onto the exterior **Frame** of the Sliding Patio Door.

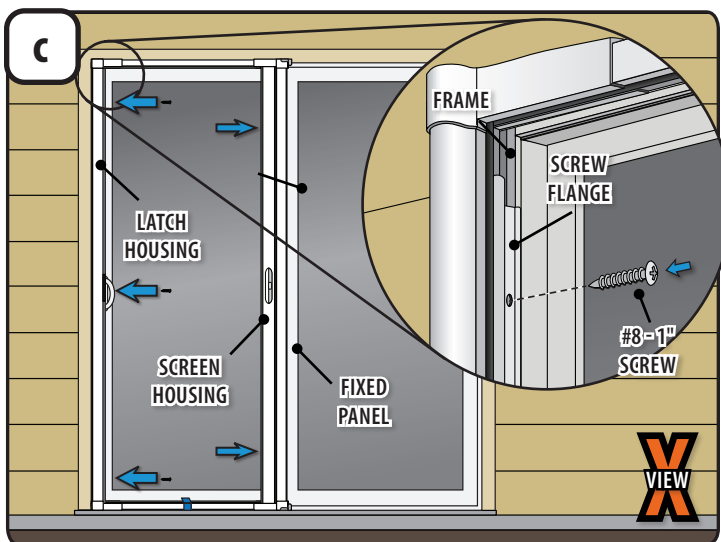

**c1** Hold the **Latch Housing** side **Screw Flange** tight to the patio door **Frame** and reinstall the #8x1" Screws from the red screw pack. Do not overtighten.

**c2** Slide **Screen Housing** side over until the **Screen Housing** mounting flange makes contact with the patio door **Fixed Panel**.

4

## PLACE AND INSTALL SCREEN ASSEMBLY INTO OPENING

### Tools Recommended:

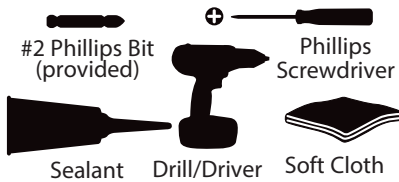

### SCREW/PACK

#6 - 3/4"  
(Qty 4)

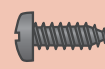

#8 - 3"  
(Qty 2)

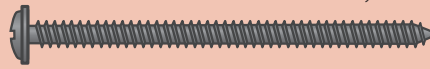

### PARTS BAG

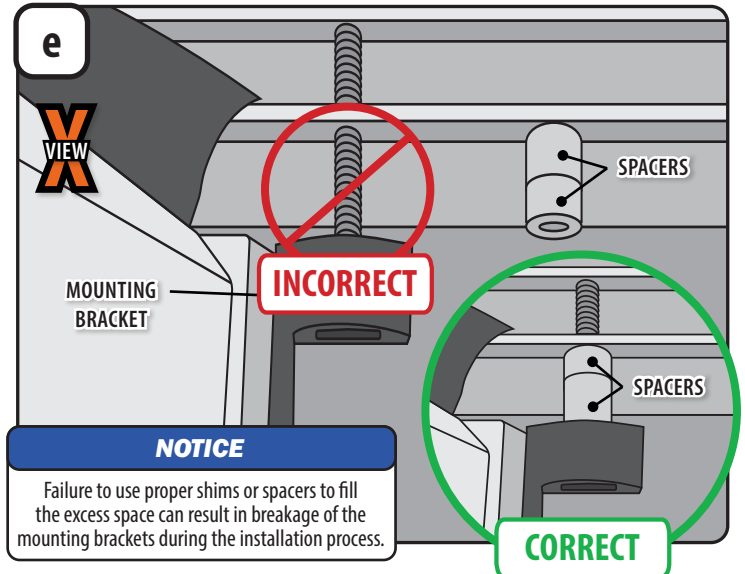
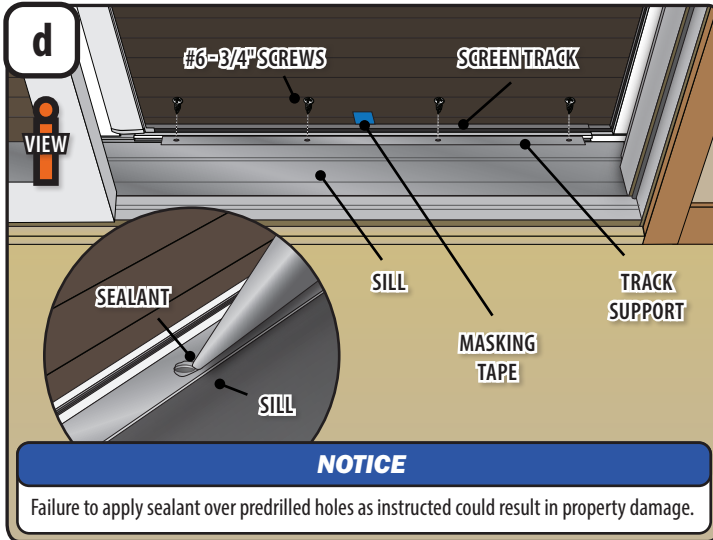
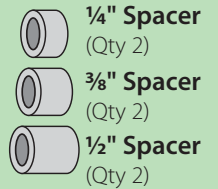

- d1** Remove **Masking Tape** from **Track Support** and **Screen Track**.
- d2** Thoroughly clean the **Track Support** and **Sill**. Align the holes in **Track Support** to the predrilled holes in the **Sill**.
- d3** Apply sealant into predrilled holes until sealant over-flows onto **Track Support** surface. Fasten using **#6-3/4 Inch Screws**. Do not to overtighten. Cleanup excess sealant with cloth.

- e1** In both of the following two steps you must fill any voids behind the **Mounting Bracket** and the patio door using the same type and amount of **Spacers** the retractable screen used when originally installed that you noted in step a, section 2.

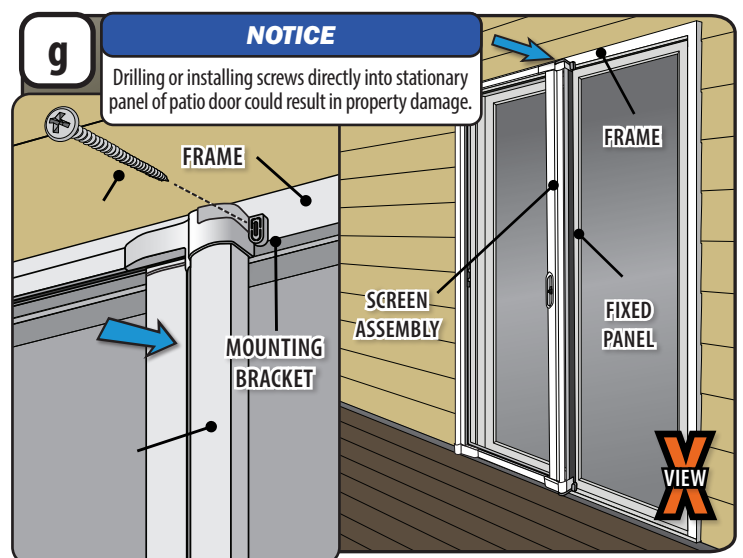
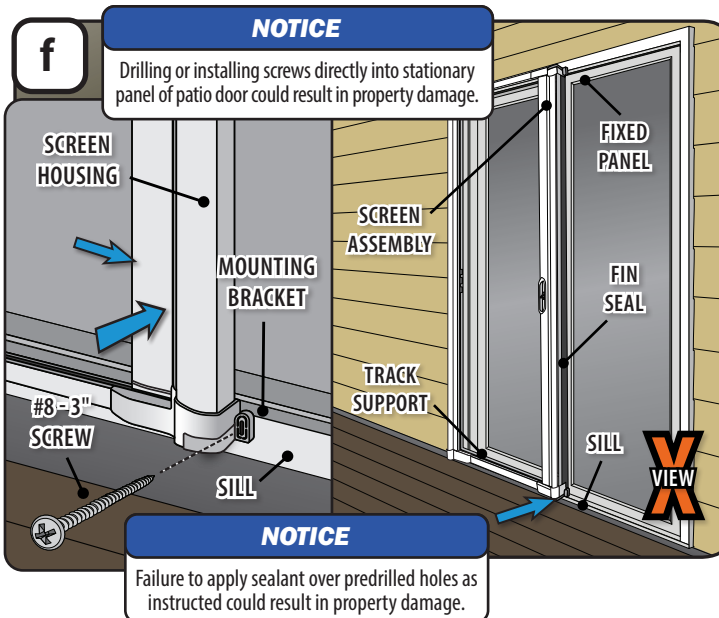

- f1** Press the **Screen Assembly** tight to the **Sill** and confirm the **Mounting Flange** is tight to the **Fixed Panel**. Verify **Fin Seal** is not behind **Mounting Bracket** or the **Mounting Flange**.
- f2** If the **Mounting Bracket** is not tight to the **Frame** use the necessary bracket spacers from the green parts bag to fill the gap. See step e
- f3** Apply sealant in the **Mounting Bracket** slot over the predrilled hole.
- f4** With the **#8 - 3" Screw**, fasten the **Screen Housing** to the patio door **Frame**. Do not overtighten.

- g1** Verify the **Screen Assembly** is tight to the **Frame** and the **Mounting Flange** is tight to the **Fixed Panel**.
- g2** If the **Mounting Bracket** is not tight to the **Frame** use the necessary bracket spacers from the green parts bag to fill the gap. See step e
- g3** With the **#8 - 3" Screw**, fasten the **Screen Housing** to the patio door **Frame**. Do not overtighten.

5

## INSTALL MOUNTING BRACKET CAPS AND TRACK FOAM FILLER

### Tools Recommended:



Scissors



Soft Cloth

### PARTS BAG

Screw Cover  
(Qty 2)



Track  
Foam Filler

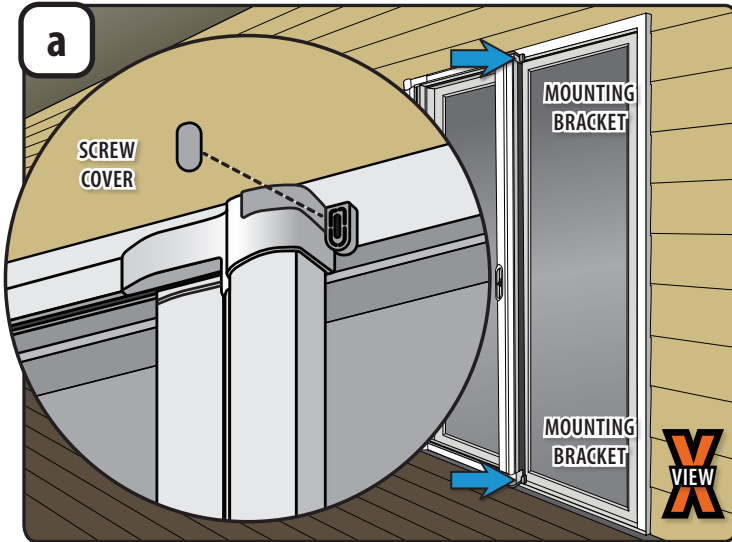
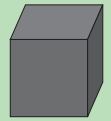

**a1** Install Screw Covers to both the upper and lower Mounting Brackets.

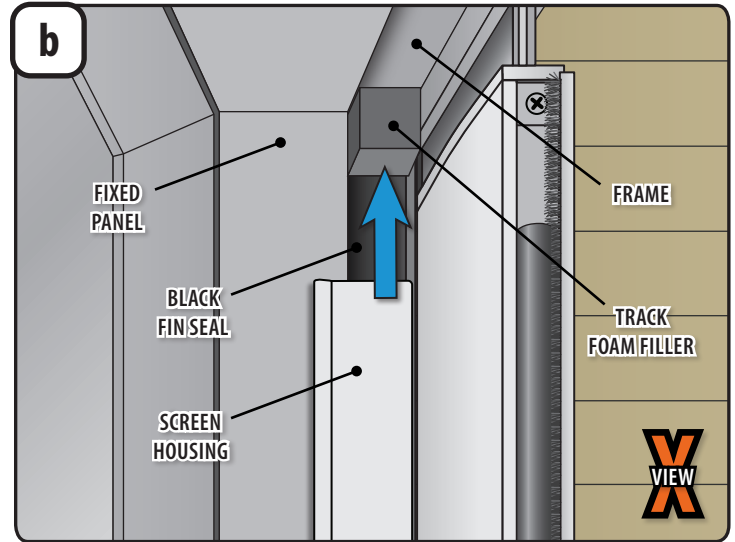

- b1** Thoroughly clean the **Frame** member above **Screen Housing**.
- b2** Arrange **Black Fin Seal** to fill in any gap that maybe between the **Fixed Panel** and the **Screen Housing**. A scissors can be used to trim the ends of the **Black Fin Seal** to the profile of your frame if desired.
- b3** If your **Track Foam Filler** need replacement, remove the old one and thoroughly clean the **Frame**. Remove paper from **Track Foam Filler** and press firmly against the **Frame** between **Fixed Panel**, the **Screen Housing** and the **Black Fin Seal**.
- b4** This is a universal installation that works on various sliding patio doors. If needed you can seal up any gaps at the bottom corners that may exist between the retractable screen and patio door.